

# ACM Series AC Servo Motors (100W/200W/400W)

## Introduction

The ACM series of AC servo motors offer high performance with modes ranging from 100W to 1500W\*. Mounting is compatible with Panasonic and Fuji AC servo motors. Standard models come with a standard 2500-line differential encoders with index slits (A, B, Z), and Hall Sensors (U, V, W).

When driven by Leadshine ACS series and ACH series servo drives, the ACM series motors meet application requirements from as low as 1 rpm to as high as 4000 rpm.



100W AC Servo Motors

200W AC Servo Motors

400W AC Servo Motors

\*Motors rated above 400W are coming soon.

## Part Number

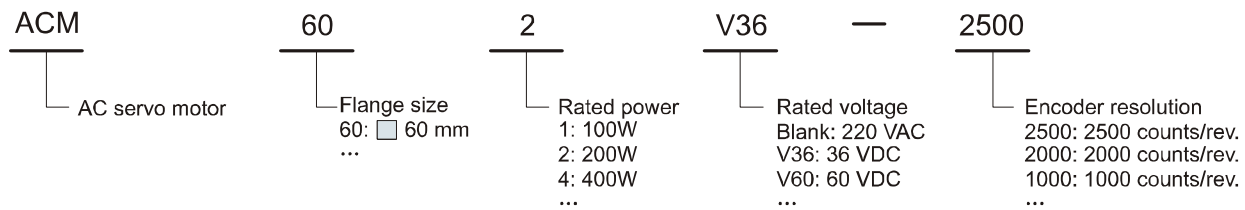

## Electrical Specifications (Visit [www.leadshine.com](http://www.leadshine.com) for information about other servo motors.)

Model	ACM601V36	ACM602V36(A)	ACM602V60(A)	ACM604V60	ACM604	ACM602V36-01	ACM604V60-01
Rated Voltage (V)	36	36	60	60	220	36	60
Rated Power (W)	100	200	200	400	400	200	400
Rated Torque (N.M)	0.318	0.64	0.64	1.27	1.27	0.64	1.27
Peak Torque (N.M)	0.95	1.91	1.91	3.82	3.82	1.92	3.81
Rated Speed (RPM)	3000	3000	3000	3000	3000	3000	3000
Peak Speed (RPM)	4000	4000	4000	4000	5000	4000	4000
Rated Current (A)	4	7.6	4.7	8.4	2.8	7.6	8.4
Peak Current (A)	11	22	14	25	8.5	22	25
Torque Const. (N.M/A)	0.0866	0.0918	0.15	0.161	0.49	0.084	0.151
Back EMF Const. (V/RPM)	$3.03 \times 10^{-3}$	$3.213 \times 10^{-3}$	$5.24 \times 10^{-3}$	$5.54 \times 10^{-3}$	$17 \times 10^{-3}$	$3.2 \times 10^{-3}$	$5.5 \times 10^{-3}$
Resistance (ohm)	0.38	0.16	0.38	0.19	1.42	0.39	0.28
Inductance (mH)	0.91	0.41	1.07	0.59	6	0.33	0.34
Inertia ( $\text{kgm}^2 \times 10^{-4}$ )	0.1032	0.176 (0.296)	0.176 (0.296)	0.3549	0.3549	0.32	0.46
Allowable radial load (N)	78.6	245	245	245	245	245	245
Allowable axial load (N)	38.2	68	68	74	74	68	74
Flange Size (mm)	60	60	60	60	60	60	60
Mounting Diameter (mm)	70	70	70	70	70	70	70
Shaft Diameter (mm)	8	11 (14)	11 (14)	14	14	11	14
Motor Length (mm)	86.7	100.7	100.7	127.8	127.8	123	143
Pole Pairs (-)	4	4	4	4	4	4	4
Encoder Res. (counts/rev.)	2500 **	2500 **	2500 **	2500 **	2500 **	2500 **	2500 **
Mass (Kg)	0.701	0.966	0.984	1.463	1.48	0.95	1.48
Ambient Temperature (°C)	0 to 40	0 to 40	0 to 40	0 to 40	0 to 40	0 to 40	0 to 40

\*\* Standard. Other configurations available, see Part Number.

## Mechanical Specifications (Units: mm 1 inch = 25.4 mm)

(a) Mechanical specifications of the ACM601V36 (100W)

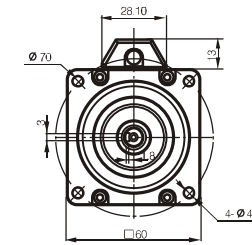

(b) Mechanical specifications of the ACM602V36A and the ACM602V60A (200W)

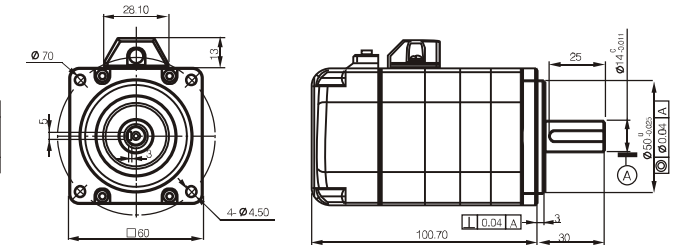

(c) Mechanical specifications of the ACM602V36 and the ACM602V60 (200W)

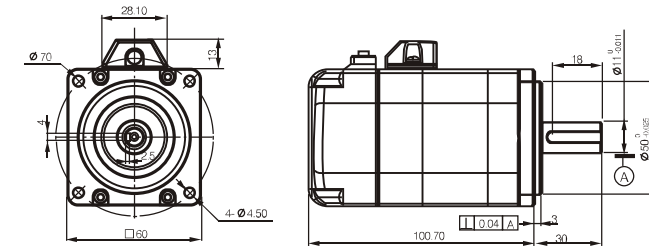

(d) Mechanical specifications of the ACM604V60 and the ACM604 (400W)

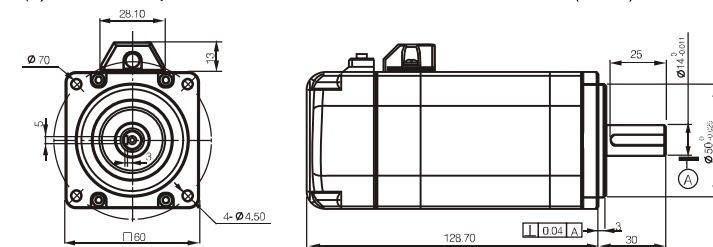

(e) Mechanical specifications of the ACM602V36-01 (200W)

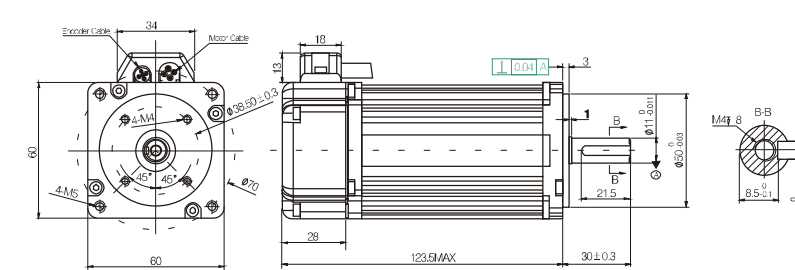

(f) Mechanical specifications of the ACM604V60-01 (400W)

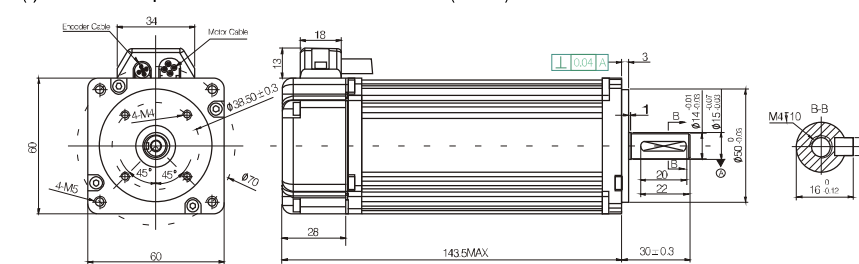

## Matching Drives

Models	Matching Drives
100 W AC Servo Motors	ACS806
200 W AC Servo Motors	ACS806
400 W AC Servo Motors	ACS806, ACH1000